



SEASONAL WORLD

WE BUILD BACKYARDS!

532 Monmouth Road Clarksburg, NJ 08510

☎ 609-259-8330 📠 609-259-8333

NJ HIC REG # 13VH00772700 - PA HIC REG #PA077494

Plan Status: Final
Creation Date: September 9, 2021
Created By: John Perez
Contract #: 2021-1111
Pool Type: Concrete / Vinyl

POOL LAYOUT PLAN

[SHEET 1 OF 1]

Sameer Deshpande

9 Duchess Drive Monroe, NJ 08831

Revision History

#		Date	Details

SEASONAL WORLD
APPROVAL

x _____
Signature Date

BUYER APPROVAL
(AS NOTED HEREIN)

x _____
Signature Date

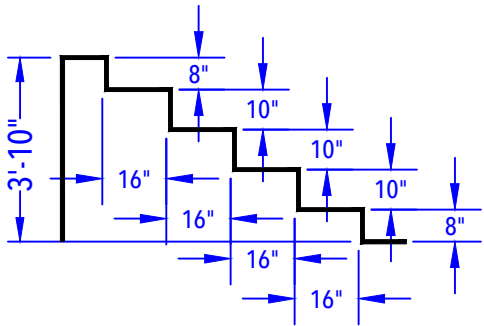

ENTRY STEP DETAIL
(After Concrete & Liner)
N.T.S.

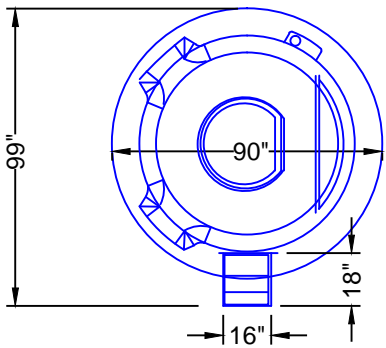
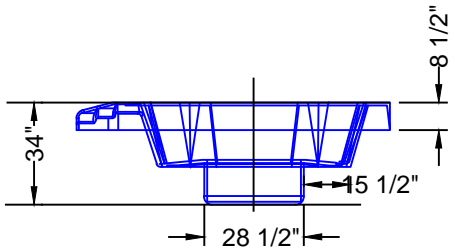

SPILOVER SPA DETAIL
(After Concrete & Liner)
N.T.S.

ADDITIONAL SPECIFICATIONS

18' x 36' - Concrete - Classic Rectangle
w/ 8'-4" x 5'-4" Exterior Vinyl Covered Step
Pool Perimeter = 116 Ln. Ft.
Pool Area = 692 Sq. Ft.
Approximate Pool Gallons: 20,688 Gallons

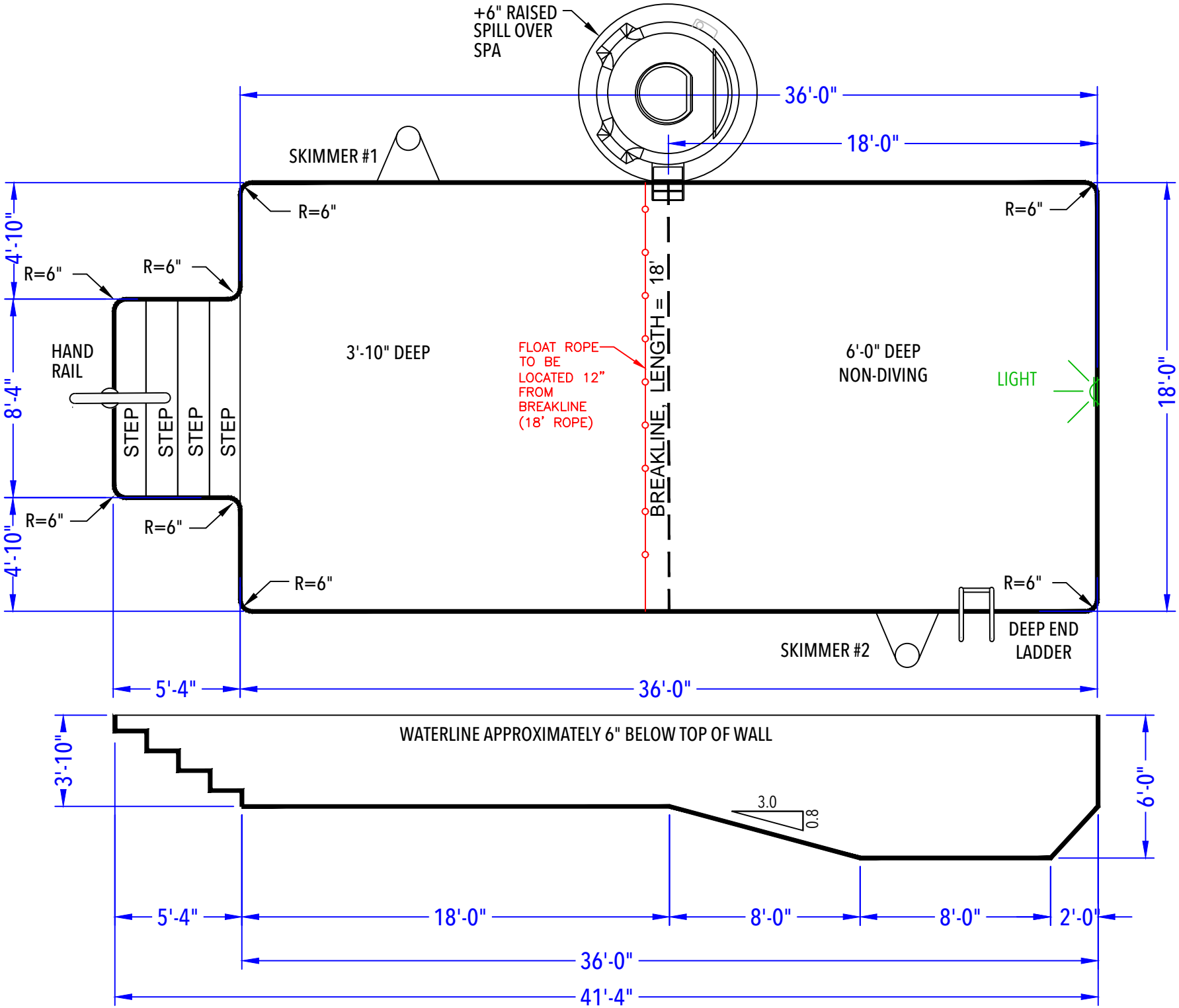

WATERLINE APPROXIMATELY 6" BELOW TOP OF WALL

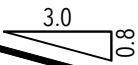

DEPTH DETAIL

SCALE: 3/16" = 1'-0"

BUYER APPROVAL & SIGN OFF

[VER: 2022-01-A]

This Pool Layout Plan attempts to detail important elements as it relates to the Buyer's project with Seasonal World for the installation of an inground swimming pool, associated features, and associated work. This Pool Layout Plan will detail work to be performed by Seasonal World and work to be performed by Buyer as detailed in the Contract. If the Plan Status as indicated in the title block area is noted as "Preliminary" then the information detailed in this plan is subject to change, adjustment and/or revisions by Seasonal World and as required. If the Plan Status as indicated in the title block area is noted as "Final" then the information detailed in this plan represents the closest version as to what will be built in the field, subject to modifications by Seasonal World as needed based on actual field conditions or other circumstances. All listed dimensions, footprints, scales, and depicted locations of proposed items are approximate in nature only and are subject to deviation from this plan in accordance with the Contract Terms and Conditions. Seeing as the general contents of the Pool Layout Plan has been reviewed by the Buyer and the Buyer's coinciding Township prior to these plans being sent to the Buyer for approval, there are no permitted changes to the Pool Layout Plan unless approved by Seasonal World. Any requested changes to the Pool Layout Plan as requested by Buyer may be subject to a revision fee which generally starts at \$500.00 per hour for changes plus additional fees as applicable. Buyer acknowledges that any changes or deviations to these plans as requested or done so by Buyer may be subject to approval by the Township or other governing authority and Buyer agrees to take full and complete responsibility for any changes that are made. Furthermore, any changes to the Pool Layout Plan as requested by the Buyer are subject to price changes and delays to the start date or construction durations, as applicable. Seasonal World is not responsible for any topographical errors and/or omissions that may occur in the preparing of the Pool Layout Plan. In the event that a product or service is incorrectly shown or listed in Pool Layout Plan and it has not been purchased on the Contract or via Contract Addendum by Buyer, this does not entitle the Buyer to receive said product or service. Product or service must be purchased and paid for in order for Seasonal World to provide it to the Buyer unless otherwise specified in writing. POOL LAYOUT PLAN REQUIRES A SIGNATURE FROM SEASONAL WORLD MANAGEMENT FOR IT TO BE VALID. BUYER SHOULD REVIEW ALL COINCIDING SHEETS OF THE POOL LAYOUT PLAN CAREFULLY BEFORE SIGNING. BUYER STATES THAT THEY HAVE THOROUGHLY REVIEWED ALL ASSOCIATED SHEETS THAT MAKE UP THIS POOL LAYOUT PLAN. BUYER'S APPROVAL OF THE POOL LAYOUT PLAN AFFIRMS THAT THEY ARE IN AGREEMENT WITH THE INFORMATION AND TERMS AS DETAILED HEREIN AND IN ACCORDANCE WITH THE CONTRACT TERMS AND CONDITIONS.